

PRODUCT SPECIFICATION FOR INFORMATION

FINAL SPECIFICATION

Product Name: SAW Filter
Part No: MSA-C806_30MD-A-R0

■ History List

No.	Rev. No.	Description	Date	Author	Final Approver
1	R0	Draft	2021.12.21	Bryan Jeon	Michael Jeon

■ Mechanical Drawing

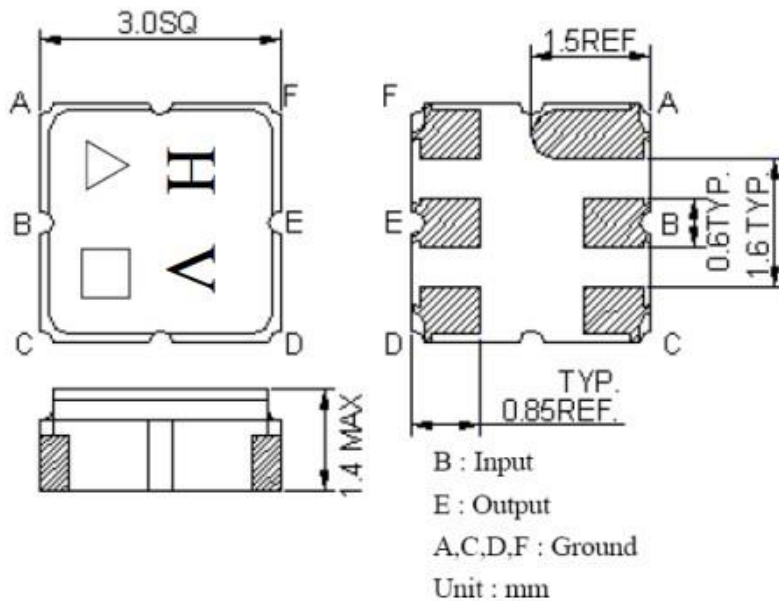

Note
1. Connector: SMD
2. Finish: Silver plated

△ : Year Code (2006->6, ..., 2009->9)
□ : Date Code (W01->A,W02->B,...W27->a,...,W52->z)

■ Electrical Specification

Parameter	Specification	Remark
1. Center Frequency	806MHz	
2. Bandwidth [BW]	Fc ±15MHz[791~821MHz]	
3. Insertion Loss in BW	4.5dB Max.	
4. Amplitude Ripple in BW	3.0dB Max.	
5. VSWR in BW	2.5:1 Max.	
6. In/Out Impedance	50Ω	
7. Attenuation [Absolute Value]	45dB Min. @ DC~760MHz	
	30dB Min. @ 760~775MHz	
	8dB Min. @ 832~862MHz	
	30dB Min. @ 862~900MHz	
	45dB Min. @ 900~1500MHz	
	35dB Min. @ 1500~2000MHz	
8. Input Power Level	10dBm	
9. DC Voltage	3V	
10. Operating Temperature	-25°C to +75°C	
11. Storage Temperature	-30°C to +85°C	

Remarks: This is a preliminary datasheet for reference.

Simulation Data

1) Transfer Functions

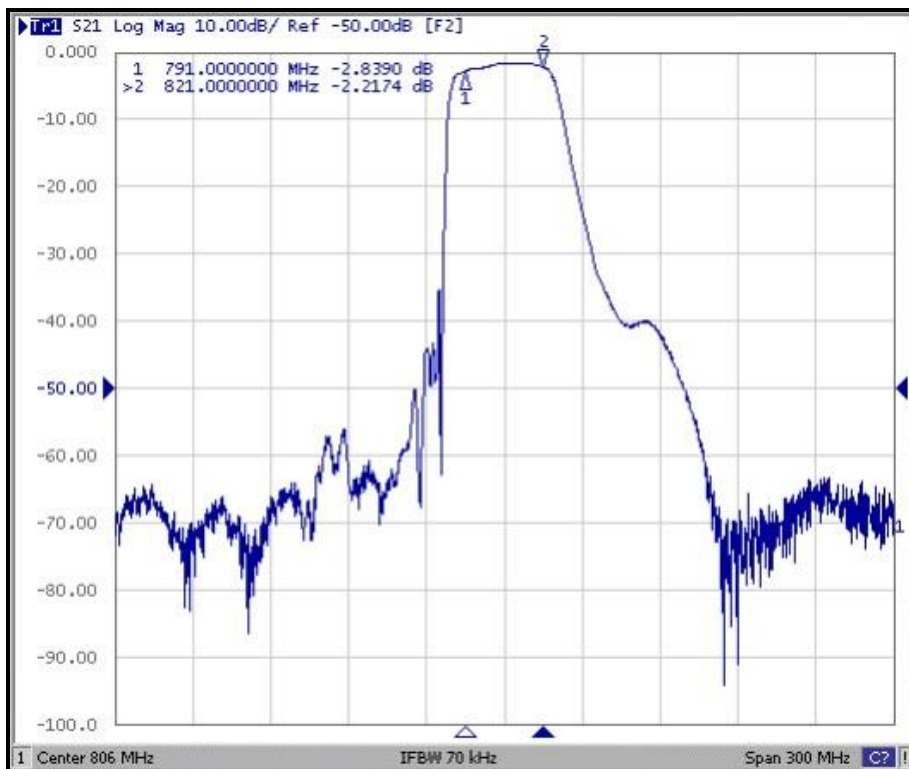
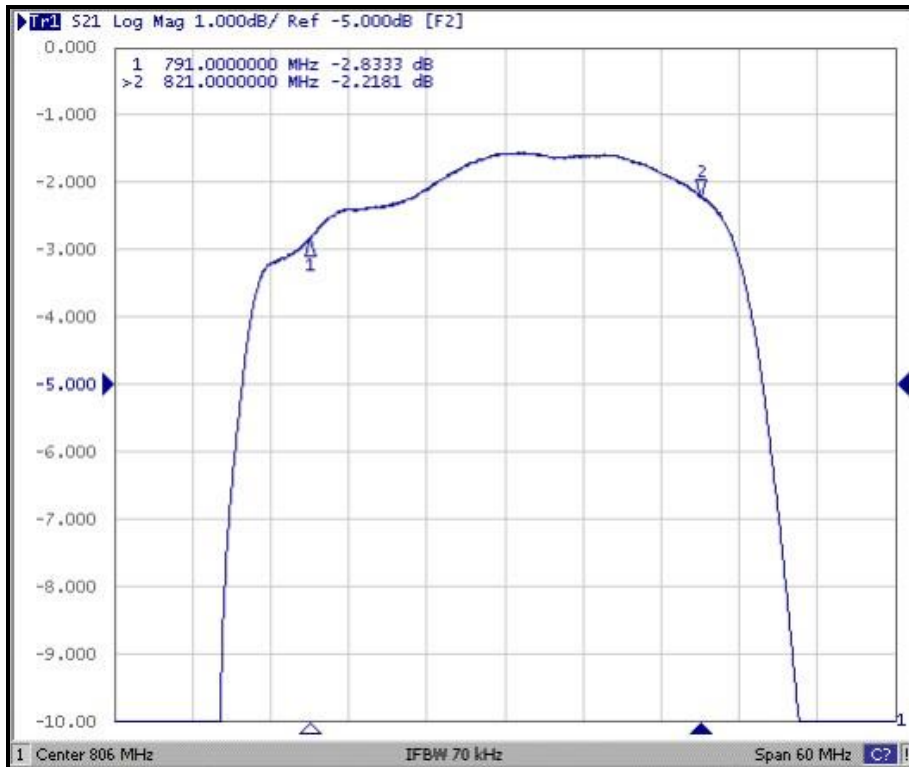

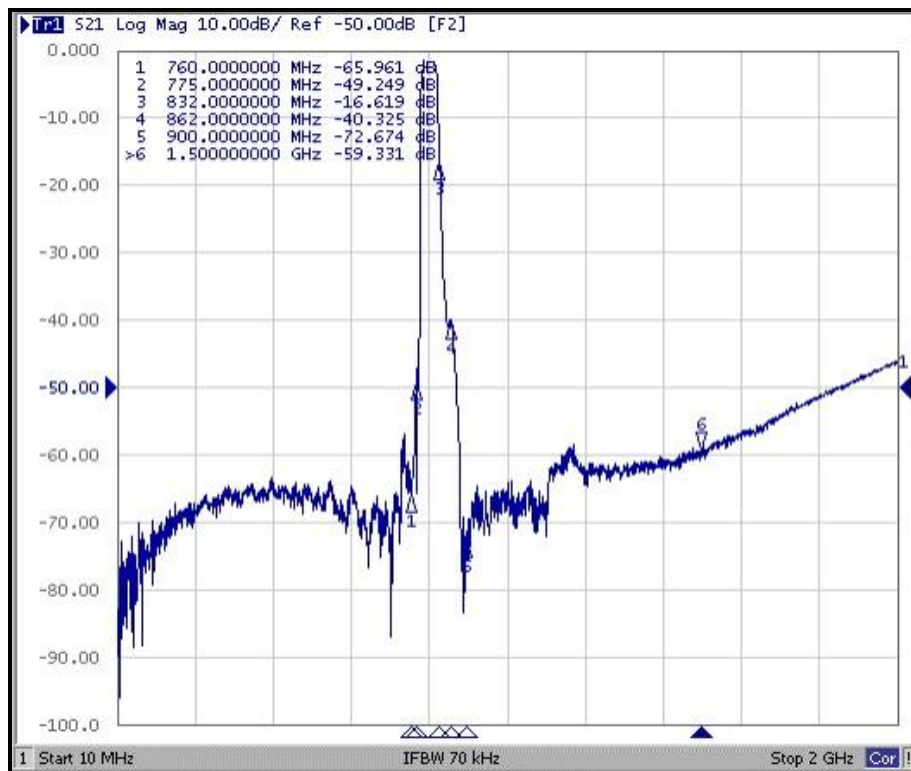

2) Reflections Functions

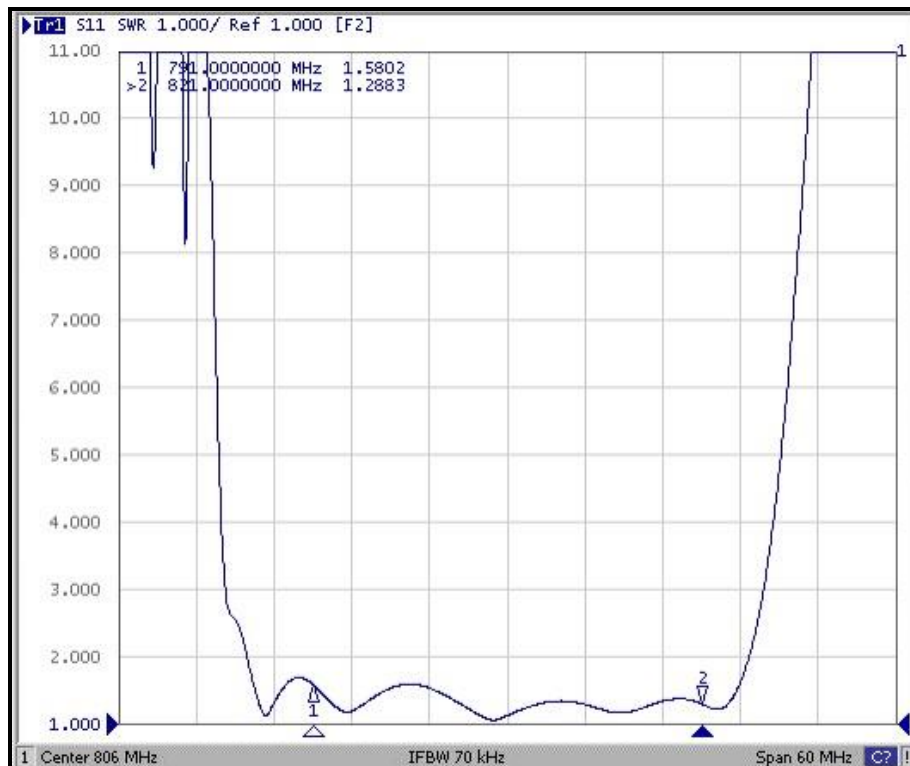

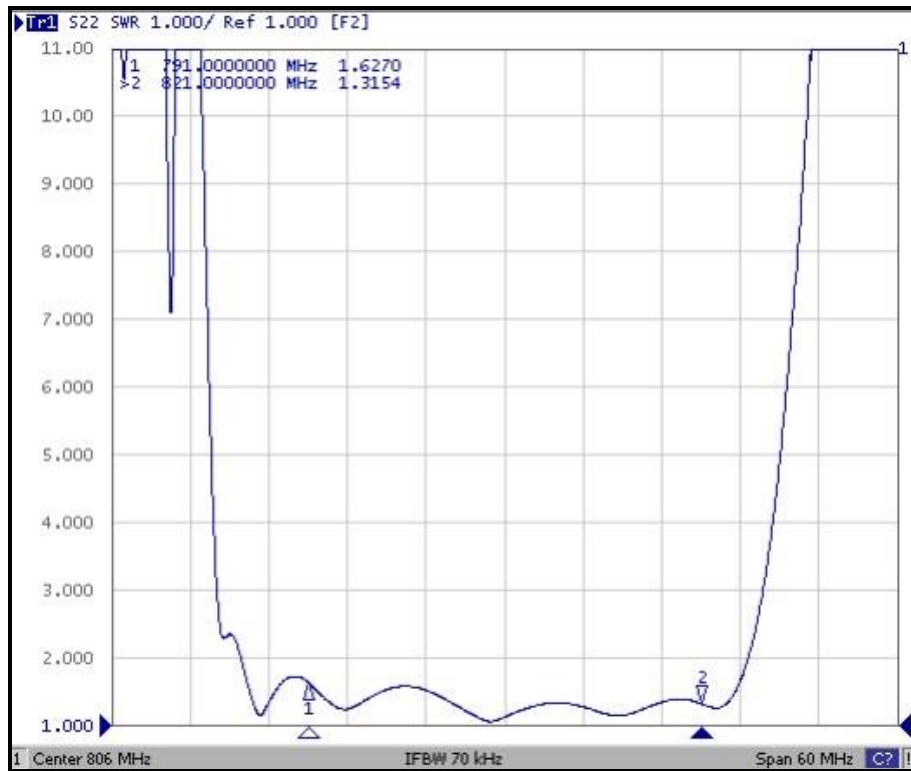

■ Packing

1. REEL DIMENSION

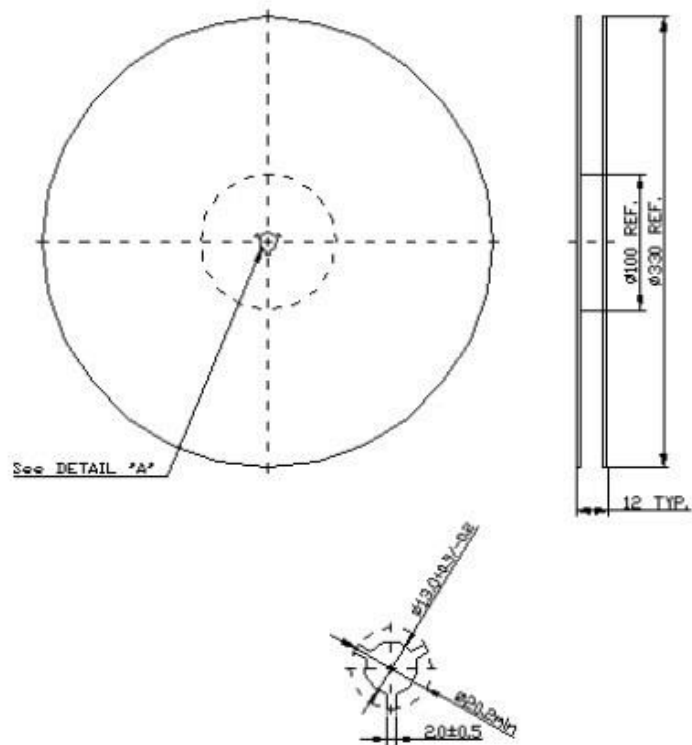

2. TAPE DIMENSION

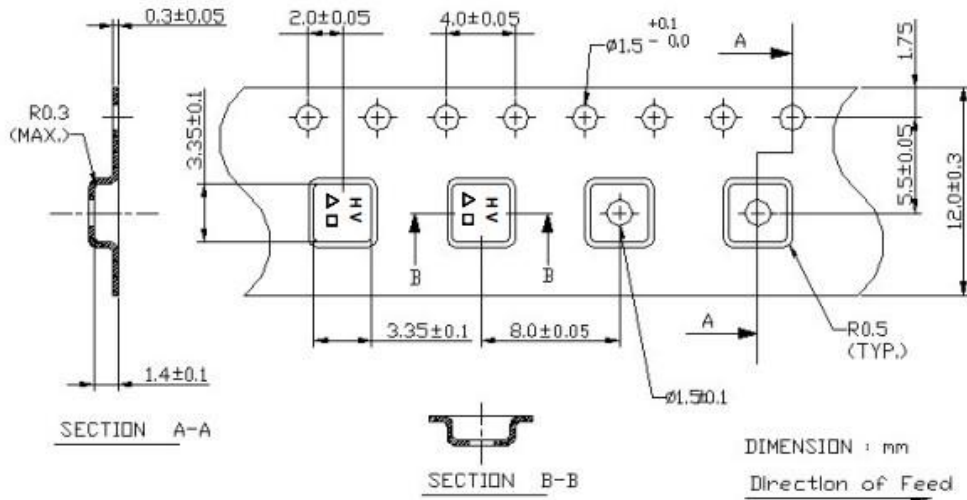

■ Recommended PCB Board Pattern

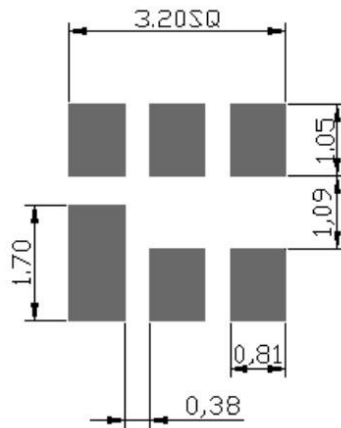

■ Recommended Reflow Profile

