

## PRODUCT SPECIFICATION FOR INFORMATION

FINAL SPECIFICATION

**Product Name: SAW Filter**  
**Part No: MSA-C2140\_60MD-A-R0**

### ■ History List

No.	Rev. No.	Description	Date	Author	Final Approver
1	R0	Draft	2021.12.21	Bryan Jeon	Michael Jeon

## ■ Mechanical Drawing

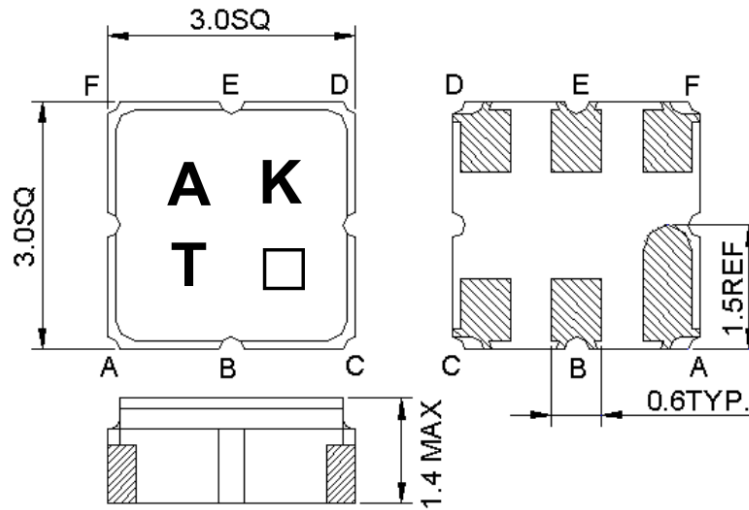

**Pin B : Input**  
**Pin E : Output**  
**Pin A,C,D,F : Ground**

□ : week code (Follow the table from planner each year)

Unit : mm

**Note**

1. Connector: SMD
2. Finish: Silver plated

## ■ Electrical Specification

Parameter	Specification	Remark
1. Center Frequency	2140MHz	
2. Bandwidth [BW]	$F_c \pm 30\text{MHz}$ [2110~2170MHz]	
3. Insertion Loss in BW	3.5dB Max.	
4. Amplitude Ripple in BW	2.0dB Max.	
5. VSWR in BW	2.2:1 Max.	
6. In/Out Impedance	50Ω	
7. Attenuation [Absolute Value]	21dB Min. @ DC~500MHz	
	20dB Min. @ 500~1900MHz	
	25dB Min. @ 1900~2050MHz	
	20dB Min. @ 2215~2300MHz	
	25dB Min. @ 2300~4500MHz	
8. Input Power Level	13dBm	
9. DC Voltage	0V	
10. Operating Temperature	-30°C to +80°C	
11. Storage Temperature	-40°C to +85°C	

Remarks: This is a preliminary datasheet for reference.

## ■ Simulation Data

### 1) Transfer Functions

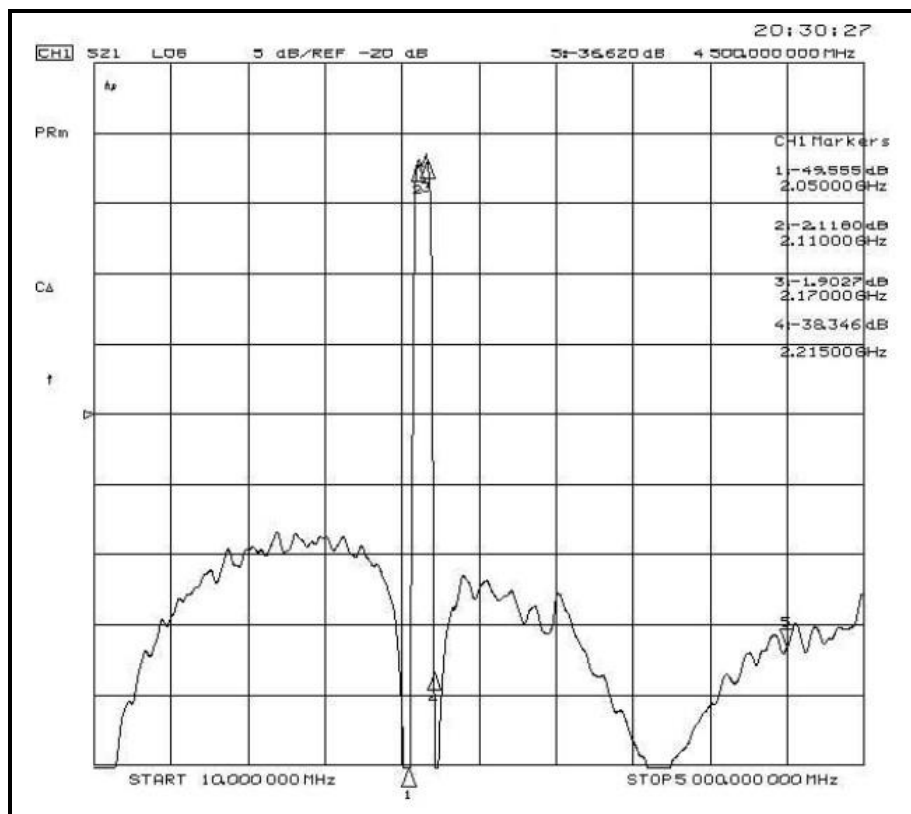
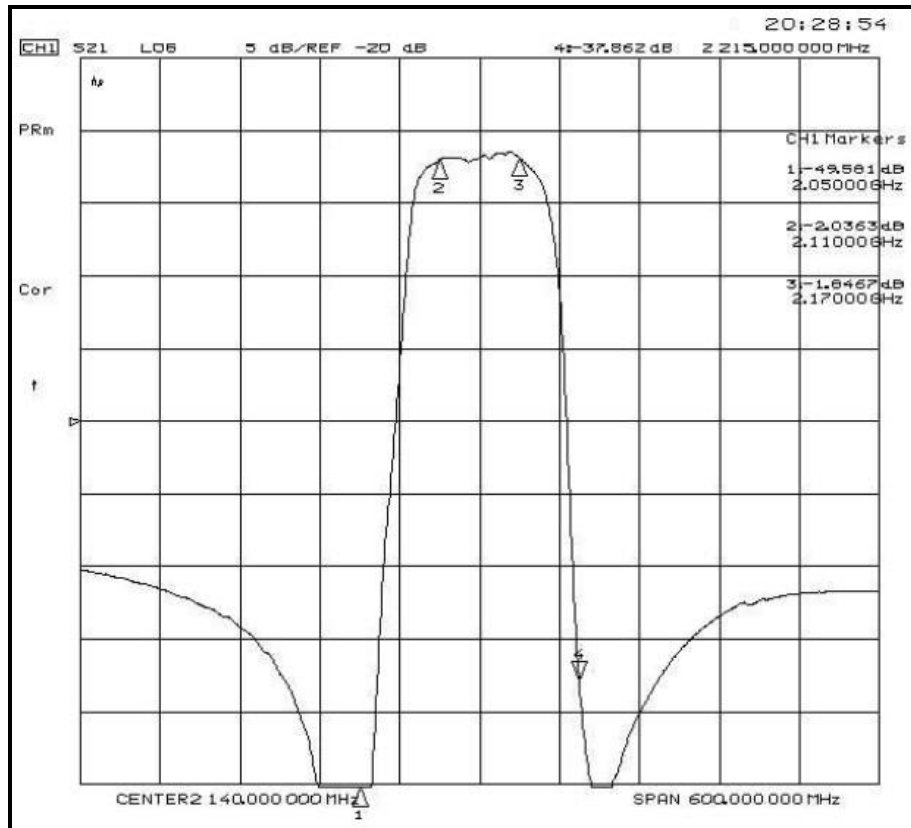

## 2) Reflections Functions

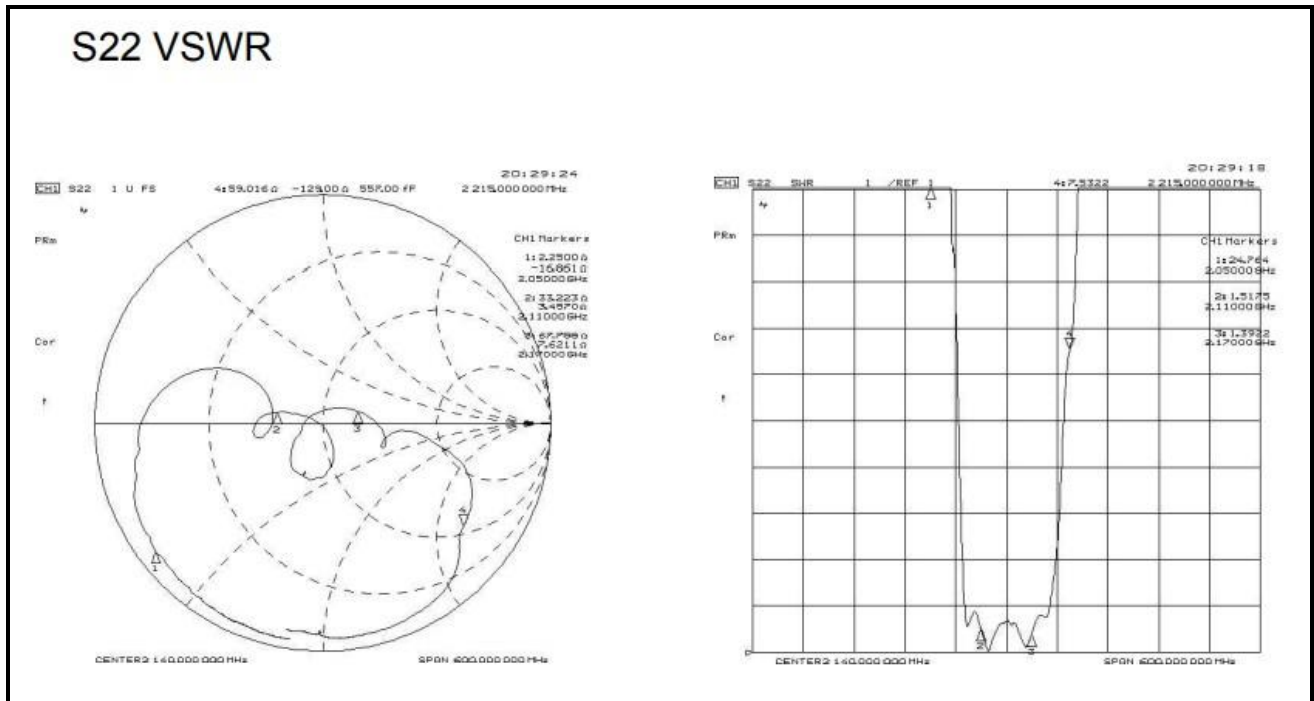
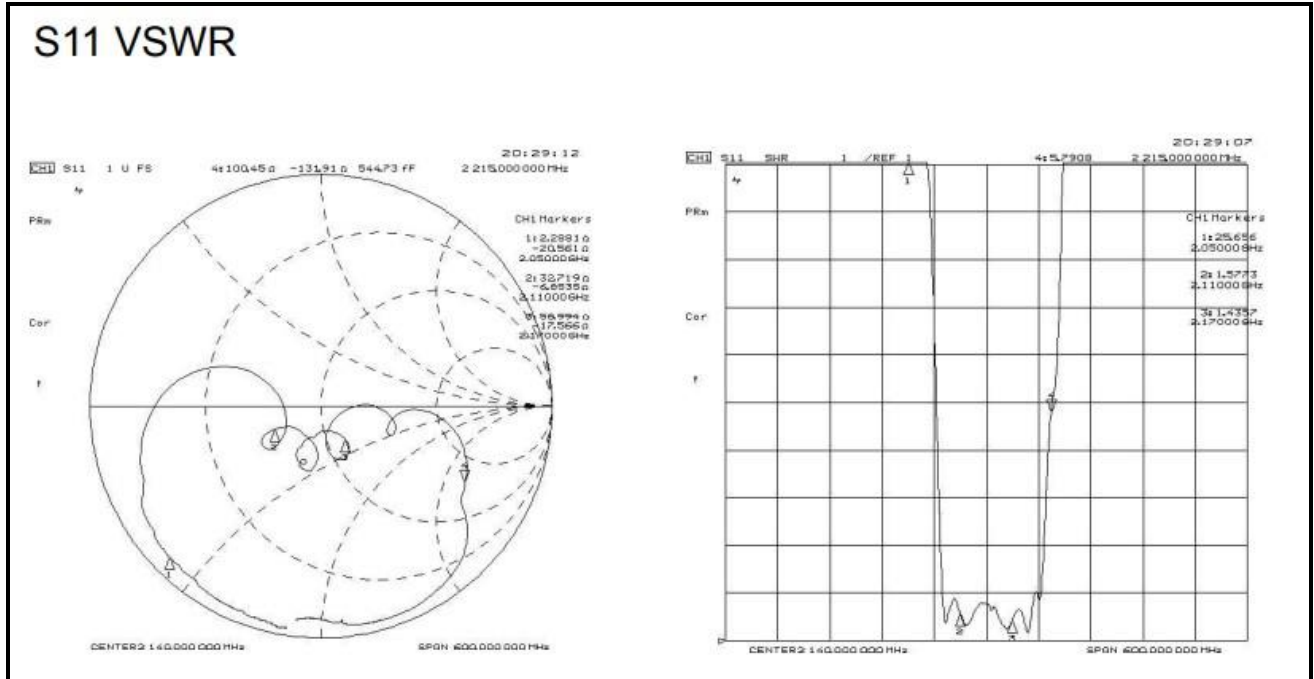

■ Packing

## 1. REEL DIMENSION

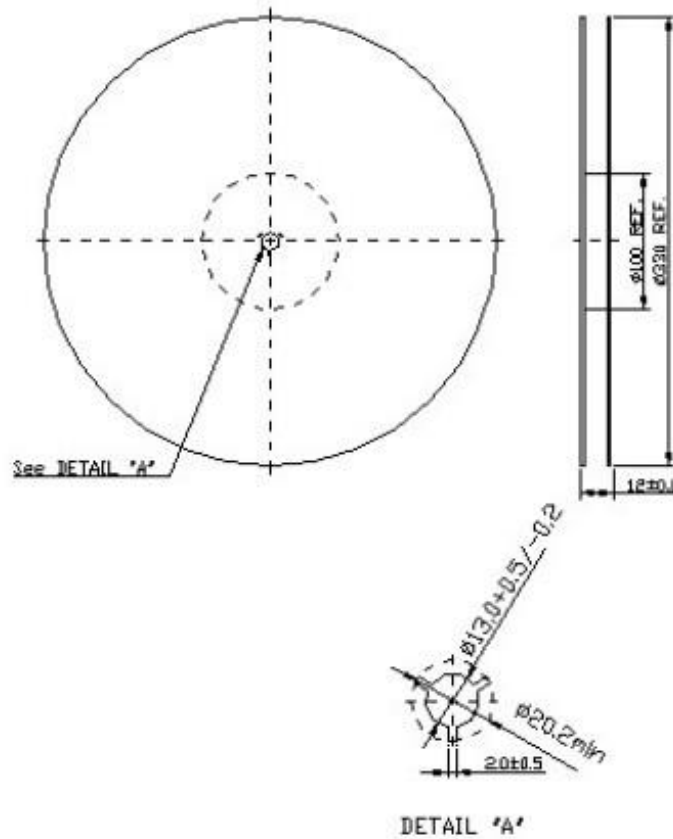

## 2. TAPE DIMENSION

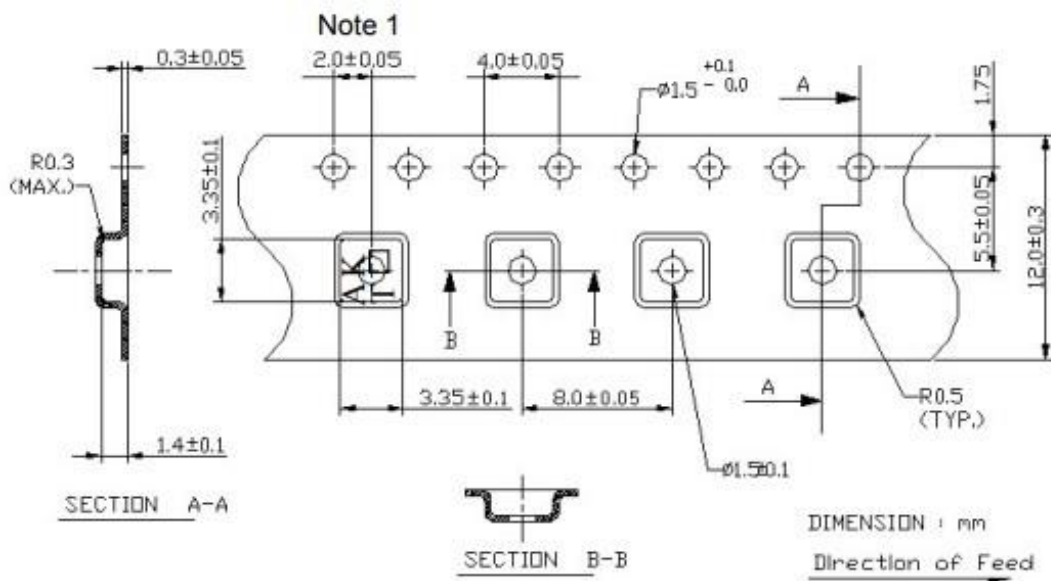

Note:

1. Pocket position relative to sprocket hole measured as true position of pocket, not pocket hole.

■ Recommended PCB Board Pattern

